

AP-30W

Operating instructions

Thank you for buying our air cleaner. Each system is carefully manufactured and subjected to a test run to ensure safety and reliability. Please read the instructions carefully before initial use and save them for future reference.



ETS Products Group

www.ets-products.com

Table of contents

Scope of delivery _____	03
Specifications _____	03
Areas of application _____	04
System overview _____	05
Wall mounting _____	06
Remote control _____	07
Control and display field _____	08
Tuya app control _____	10
Maintenance and cleaning _____	14
Filter replacement _____	16
Safety instructions _____	17
Contact _____	18

CE RoHS



TuyaSmart App Steuerung;
available in Apple App Store &
Google Play Store.

Scope of delivery

Air cleaner:	1
Power cable:	1
Operating instructions:	1
Remote control:	1
Mounting plate:	1
Mounting dowels:	6

Specifications

Air volume (CADR):	200 m ³ /h
Mains voltage*:	220 V / 240 V
Frequency*:	50 Hz
Power:	60 W
Dimensions (mm):	520 x 310 x 140
Weight:	8,9 kg
Ambient temperature:	5 °C – 40 °C
Relative humidity:	< 80%
Noise level::	~ 54 dB bei höchster Lüfterstufe

* Voltage and frequency depend on the standard of the country or region in which the devices are used. Device data can be found on the product label. Use only devices that are intended for your region.

Areas of application

The system is equipped with a highly efficient filtration and cleaning system including a HEPA H13 filter, an activated carbon filter, a titanium dioxide photo-catalyst filter, a UV sterilization lamp with a 254-nm wavelength, and a plasma generator.

ETS air cleaning systems are used to effectively remove toxins, viruses, bacteria, pathogens, dust, allergens, and odors from the ambient air.

System overview

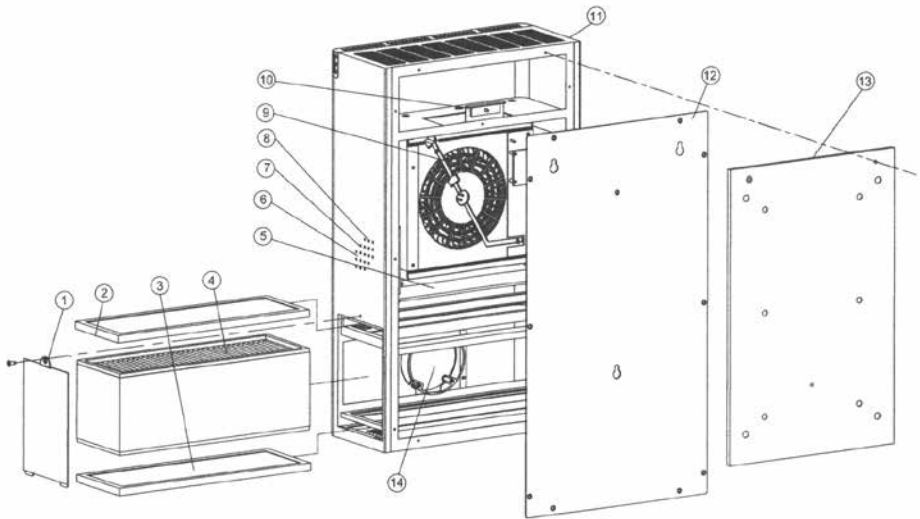

- | | |
|------------------------------------------------|--------------------------|
| 1 Maintenance panel | 8 PM2.5-Sensor |
| 2 TiO ₂ photocatalyst | 9 Fan |
| 3 Prefilter | 10 Plasma generator |
| 4 HEPA H13 filters and activated carbon filter | 11 Primary housing |
| 5 UV-C lamp | 12 Air cleaner rear wall |
| 6 TVOC | 13 Wall-mounting plate |
| 7 Temperature/moisture sensor | 14 Control board |

- Four-layer air filter and four-stage air cleaning
- High-precision particle sensors and organic gas sensors installed for real-time air quality testing
- Remote control, manual controls, and night mode
- Four cleaning modes:
 - 1) Manual, 2) Auto, 3) Quick cleaning
 - 4) Night operation with cleaning and four fan levels
- Warning display for replacing the HEPA H13 filter, activated carbon filter, and UV lamp

Wall mounting

Before fixing the mounting plate to the wall, ensure that there are no pipes or electrical cables in the wall.

1. Leave more than 40 cm free to the right of the plate. Leave more than 20 cm free above and to the left of the plate. The mounting plate should be placed near a power outlet.

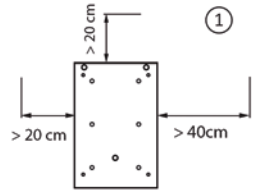

2. Use a spirit level to mount the mounting plate in the correct position. Make six marks through the holes in the mounting plate with a marking pen. Drill holes of the proper size for the dowels in the accessories package, and fix the mounting plate firmly to the wall.

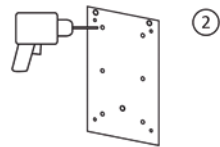

3. Fix the air cleaner to the mounting plate using the three adjustable pins.

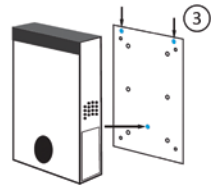

4. Connect the air cleaner to the power source.

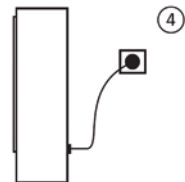

Remote control

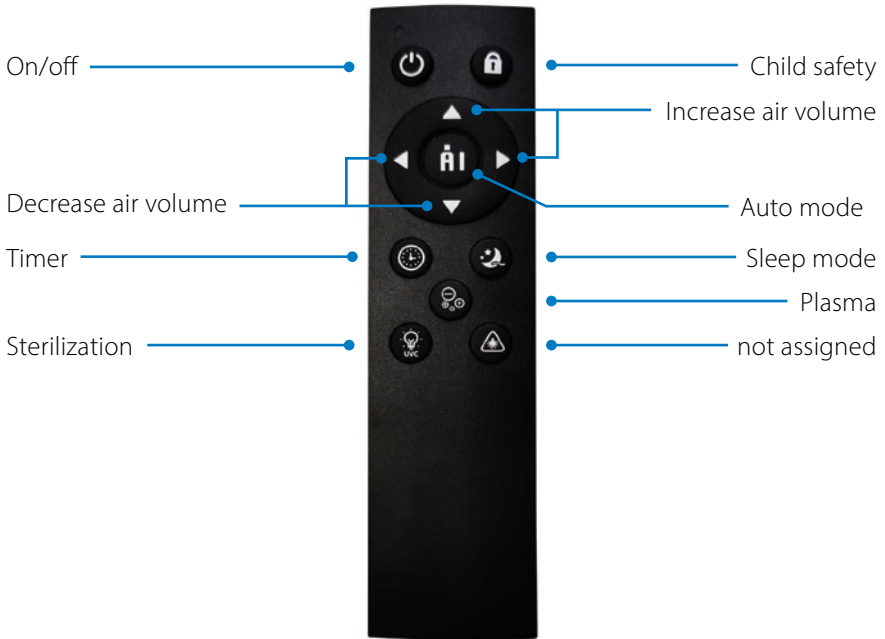

Touchscreen display

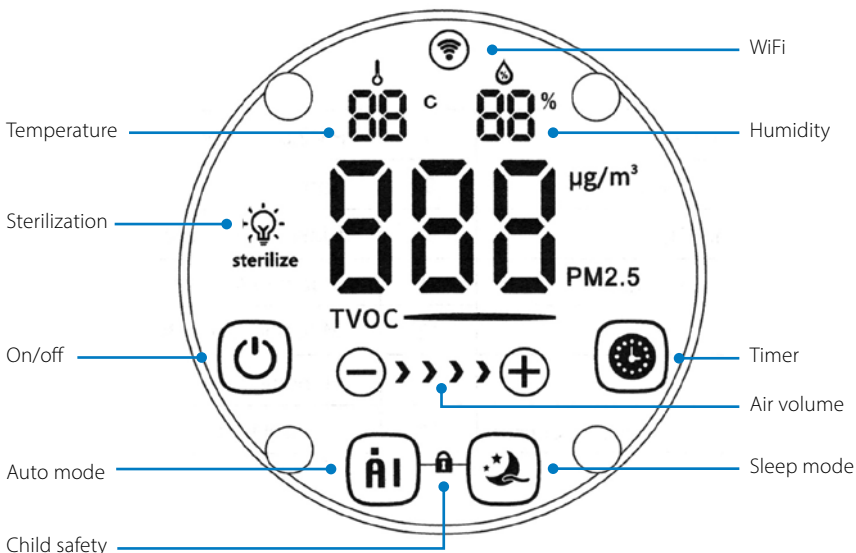

On/off

Standby mode is green. On mode is white.

Touch the On/off icon to switch the air cleaner on or off. Standard mode is manual mode with Air Volume Level 1 after the air cleaner is switched on.

Auto/manual

Manual is white, auto is green.

In manual mode: Air volume can be measured and the UV lamp switched on.

In auto mode: Sensors automatically measure the air volume for PM2.5 and TVOC. After five minutes in auto mode, the UV lamp is automatically switched on, and after 30 minutes in auto mode, it is switched back off.

Air speed

No backlighting on the user interface except for the sleep mode indicator.

Timer

Switched off – lit up white. Switched on – green. The air cleaner can be switched off automatically in 1-9 hours in 1–9 Stunden automatisch ausgeschaltet werden.

Child safety

Switched on – lit up white.

Touch the screen to switch on child safety, and touch sleep mode and the timer for three seconds to switch it back off. Child safety can be switched on and off with the remote control.

Air volume

+/- The air volume can be adjusted according to application environment.

Sterilization: Switched off: Lit up white. Switched on – green.

Sterilization

Switched off: Lit up white. Switched on – green.

Sterilization allows UV-C and plasma to be switched on and off together.

Night mode

In night mode, the display lighting switches off, and the system no longer runs at high fan levels.

Tuya Smart App Control



1. Scan the QR code in order to download and install the Tuya Smart App.

2. Get the Tuya Smart App started by clicking on „log in“ (or sign up for the first time) or „try now“ (some of the functions might be not accessible yet).

3. Connect the device to the current and touch the ON/OFF icon for 5 sec until the beep sounds. Now the pairing mode is activated and you can connect the device with your smart-phone.

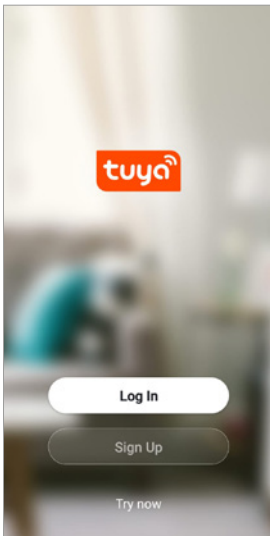

4. Click „ADD DEVICE“ then select „AUTO SCAN“ and enable „access location, Wifi and Bluetooth“.

Please ensure that the device and your smartphone is using the same network.

Click on „AUTO SCAN“ to find available devices.

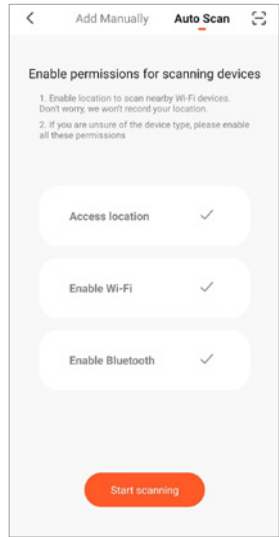
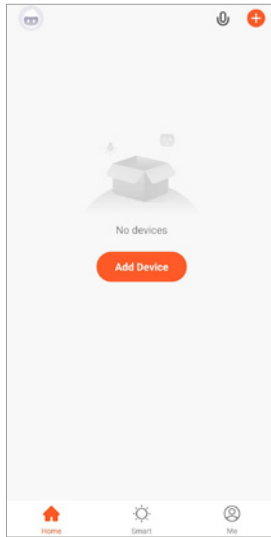
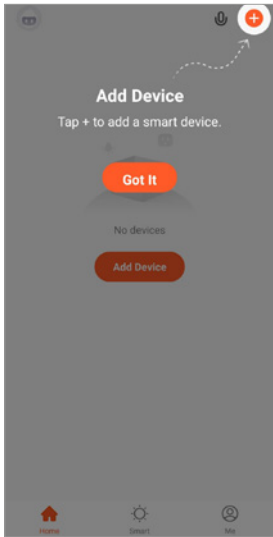

5. Select the new device on your screen and connect it with the system.

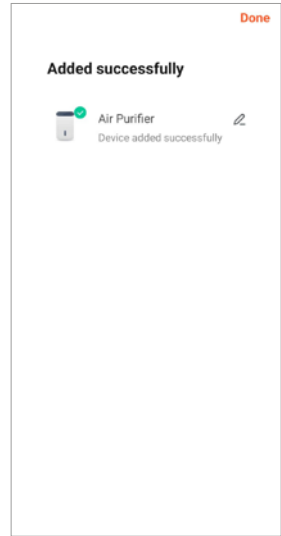
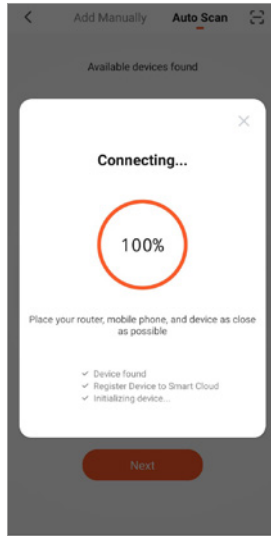

6. Now you have full control of the device via your smartphone

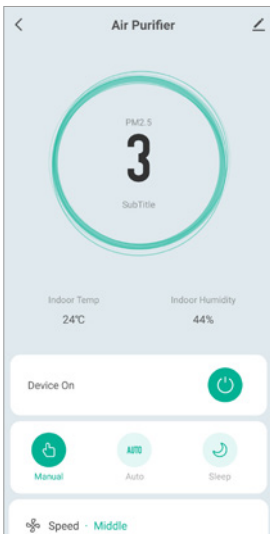

Maintenance and cleaning

To clean the air, the system uses several filters and air cleaning systems simultaneously:

Prefilter

The prefilter filters out large particles such as human hair, animal hair, lint, etc.

HEPA H13 filter

The HEPA H13 filter removes smoke, dust, pollen, allergens, toxins, and fine particles larger than 0.3 μm .

Activated carbon filter

The activated carbon filter removes gases such as benzene and methanol, odors, etc.

Photocatalyst TiO filter and UV-C lamp

Eliminates viruses and bacteria in reactions with the titanium dioxide coating in conjunction with UV-C light with a wavelength of 253.7 nm.

Plasma generator

At the plasma stage, air is routed between electrodes carrying high electrical voltage. Plasma neutralizes bacteria, viruses, and mold spores.

Use only original replacement parts. They have been harmonized with device operation. Using third-party replacement parts can impair cleaning performance. Doing so invalidates the guarantee and the test results from the microbiological institute.

Switch off the device and pull the power plug before working on the machine to avoid danger of electric shock.

Note

The UV lamp is permanently installed and may be replaced by technical customer service personnel only.

Prefilter

The prefilter must be checked regularly at intervals of no longer than four weeks and cleaned as necessary.

The prefilter can be either cleaned with a vacuum cleaner or rinsed out with running water. Insert the prefilter only after it has dried completely.

HEPA H13 filters and activated carbon filters cannot be cleaned. Do not replace these filters until the system indicates that doing so is necessary.

Filter replacement

To replace the filter, open the maintenance panel on the right-hand side with a Phillips screwdriver. The individual filters can be pulled out so that they can be replaced.

Note:

Re-insert the filters as they were installed. The prefilter (netting) goes in the lower slot. Insert the composite filter with the HEPA H13 filter downwards and the activated carbon upwards. The titanium dioxide filter (metal honeycomb material) goes in the top slot.

The photocatalyst filter and the UV lamp are permanently installed and may be replaced by technical customer service personnel only.

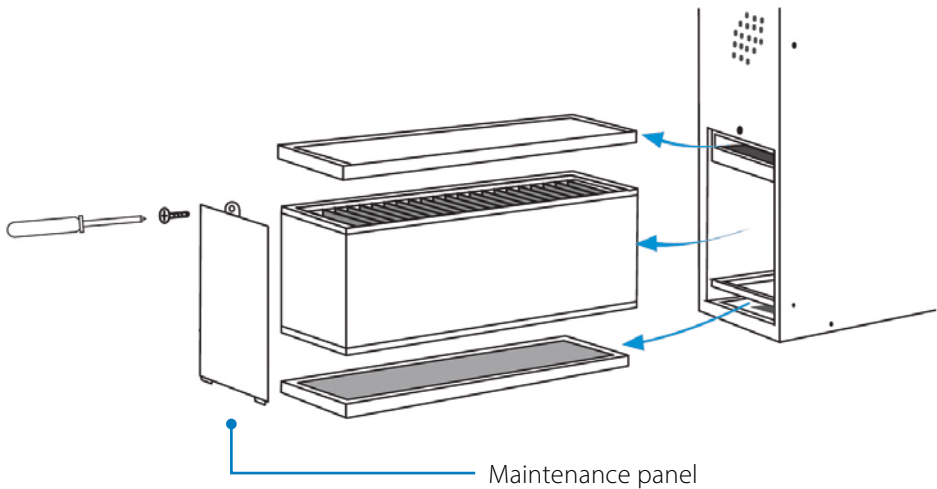

Safety instructions

- Before use, the rear housing cover must be completely closed.
- Do not open the rear cover or the maintenance panel while the device is in use.
- Before connecting the machine to the power source, ensure that the voltage indicated on the type plate is the same as the mains voltage in your region.
- Do not use the product if the plug, the power cable, or the housing is damaged.
- Keep the product away from children.
- Do not block air inlets and outlets.
- The product is suitable for dry rooms only.
- Clean the housing with a dry or slightly moist cloth.
Never use alcohol-based cleaning agents to wipe off the housing!

Manufacturer

ETS Products Philippines Inc.
Berthaphil 4 Warehouse 2C
Civil Aviation Complex Clark
Clark Freeport, Pampanga 2023 Philippines
An ETS Products Group company

Contact

Phone +49 2204/967360
E-Mail europe@ets-products.com
Internet www.ets-products.com

You can find more information and technical data about air cleaning systems on our website.



ETS Products Group